

## SOLIDWORKS TIPS AND TRICKS

### ORBITA 3D

Premere la rotellina centrale del mouse per ruotare il pezzo nello spazio.

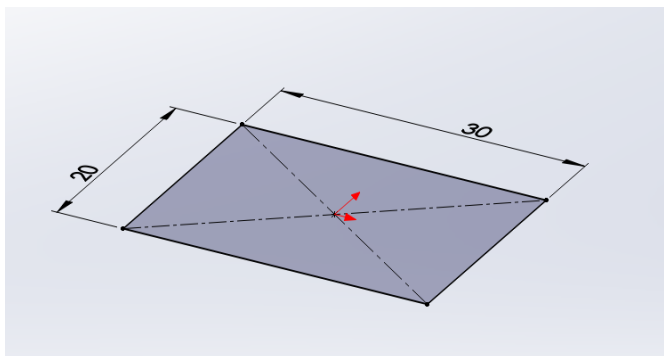

### SPOSTAMENTO 3D

Premere CTRL + "rotellina mouse" per spostare pezzo nel piano.

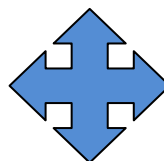
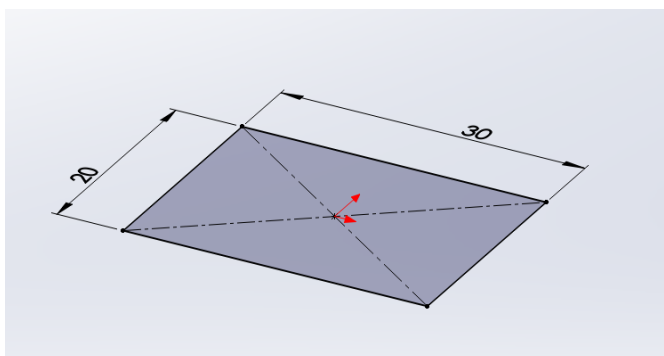

### INSERIMENTO QUOTE NEGLI SCHIZZI

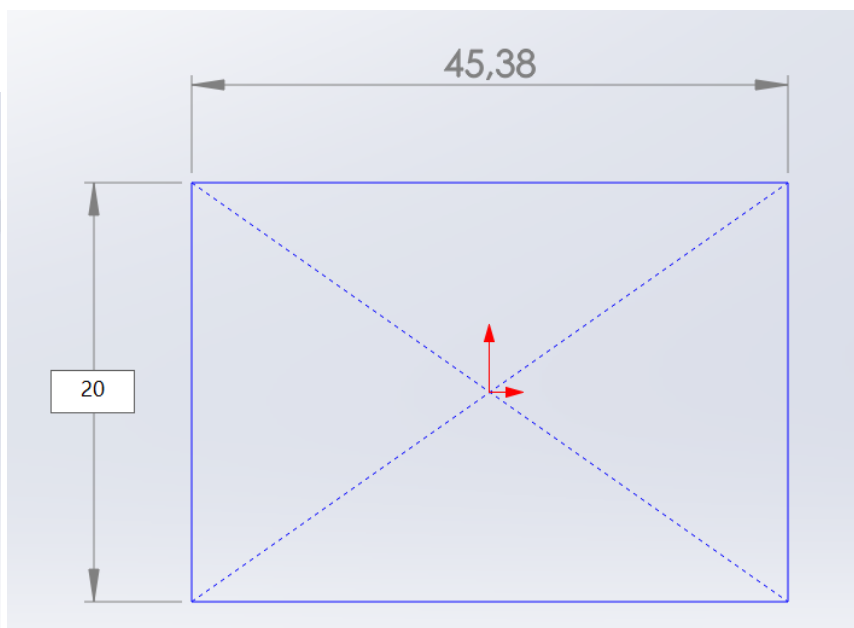
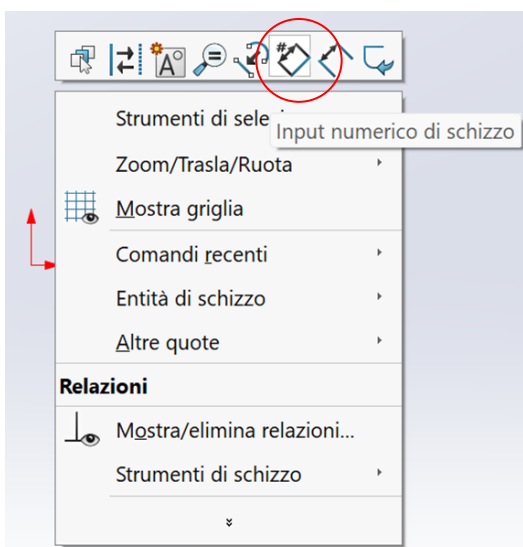

## QUOTATURA AUTOMATICA NEGLI SCHIZZI

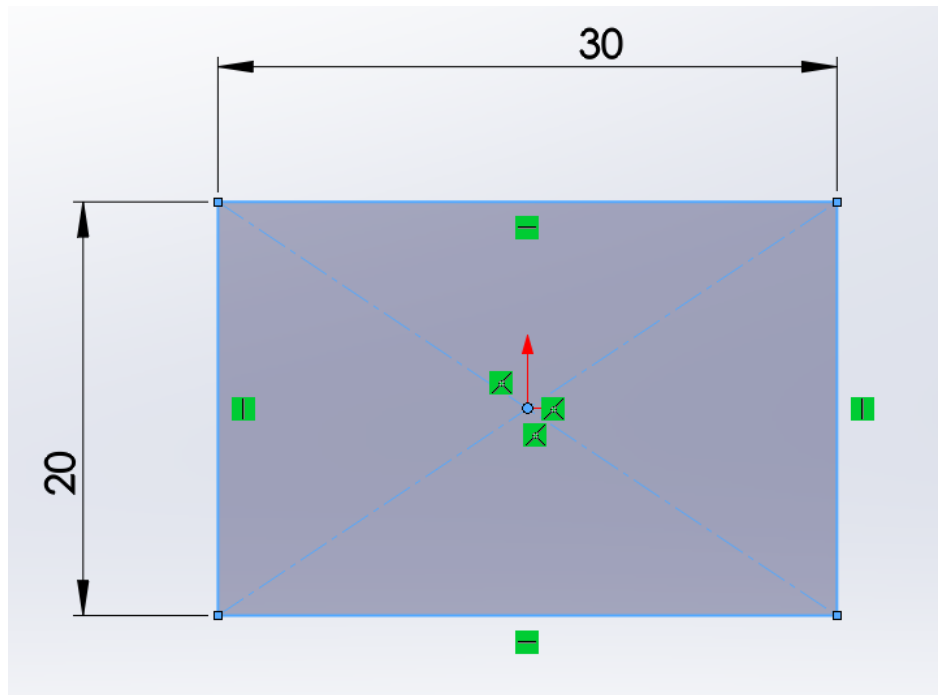
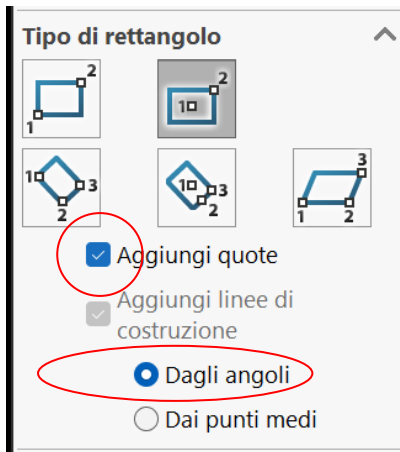

## LINEA CON LUNGHEZZA E ANGOLO

Selezionare "angolo" in orientamento per poter indicare lunghezza ed angolo.

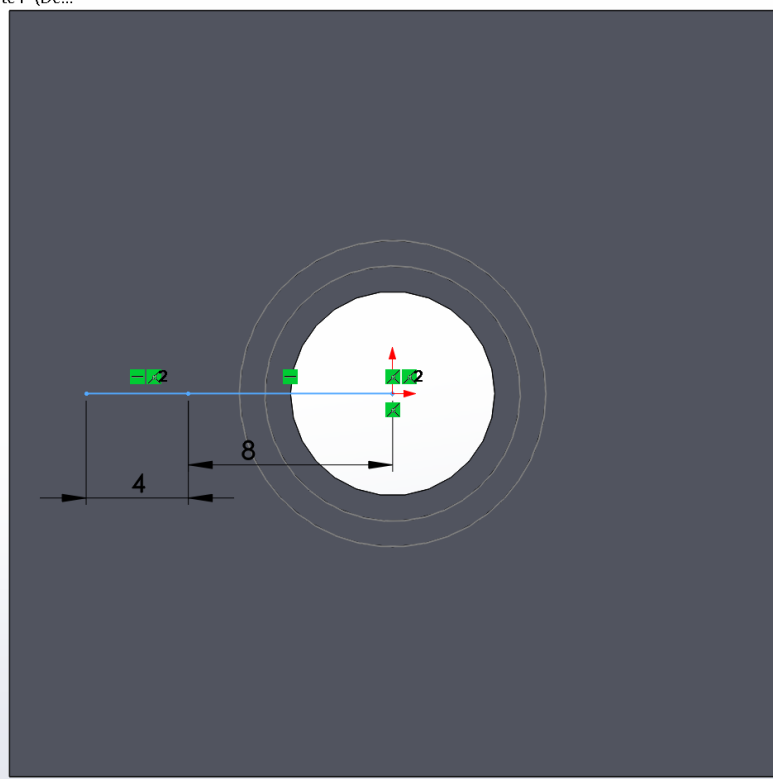
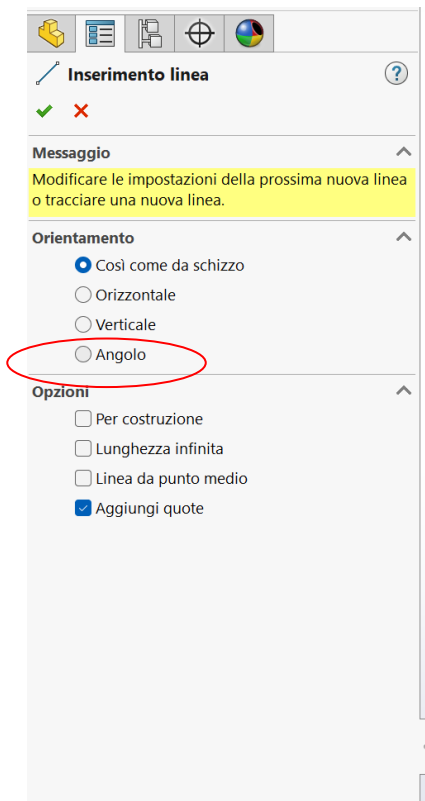

## ESTRUSIONE (POSITIVA)

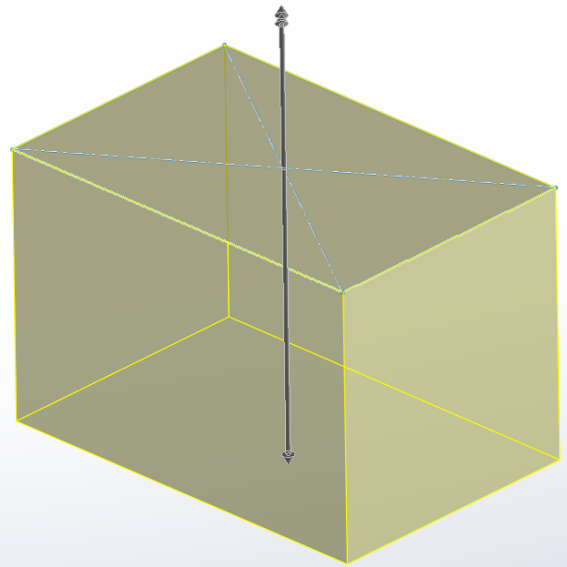
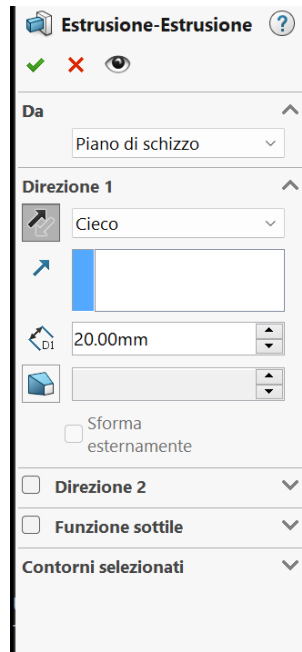
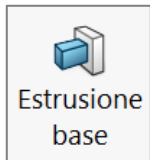

## TAGLIO ESTRUSO (ESTRUSIONE NEGATIVA)

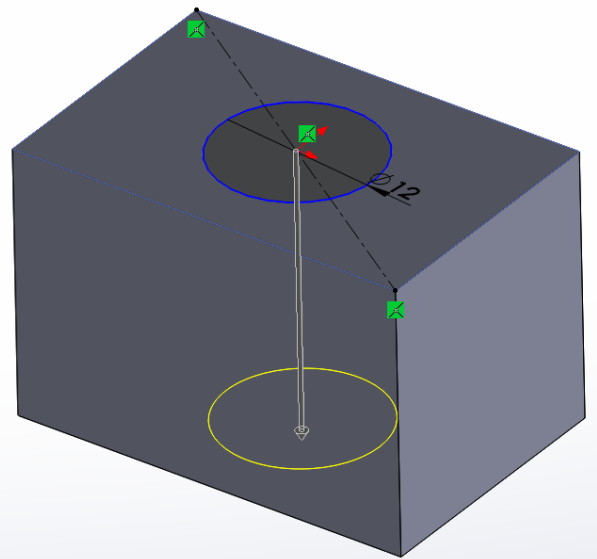
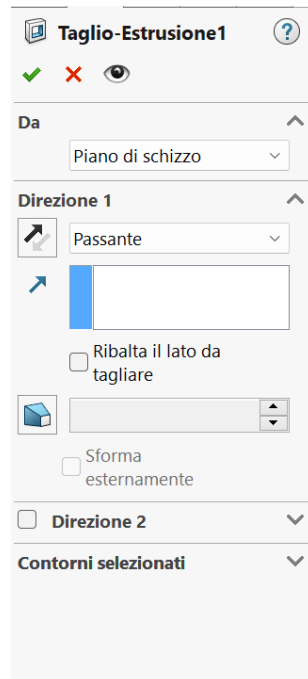
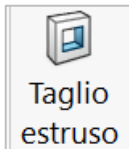

## CONVERTI ENTITA' (PROIETTA GEOMETRIA)

Per proiettare delle geometrie sullo schizzo corrente usare il comando "Converti entità".

Prima selezionare geometrie e poi applicare il comando.

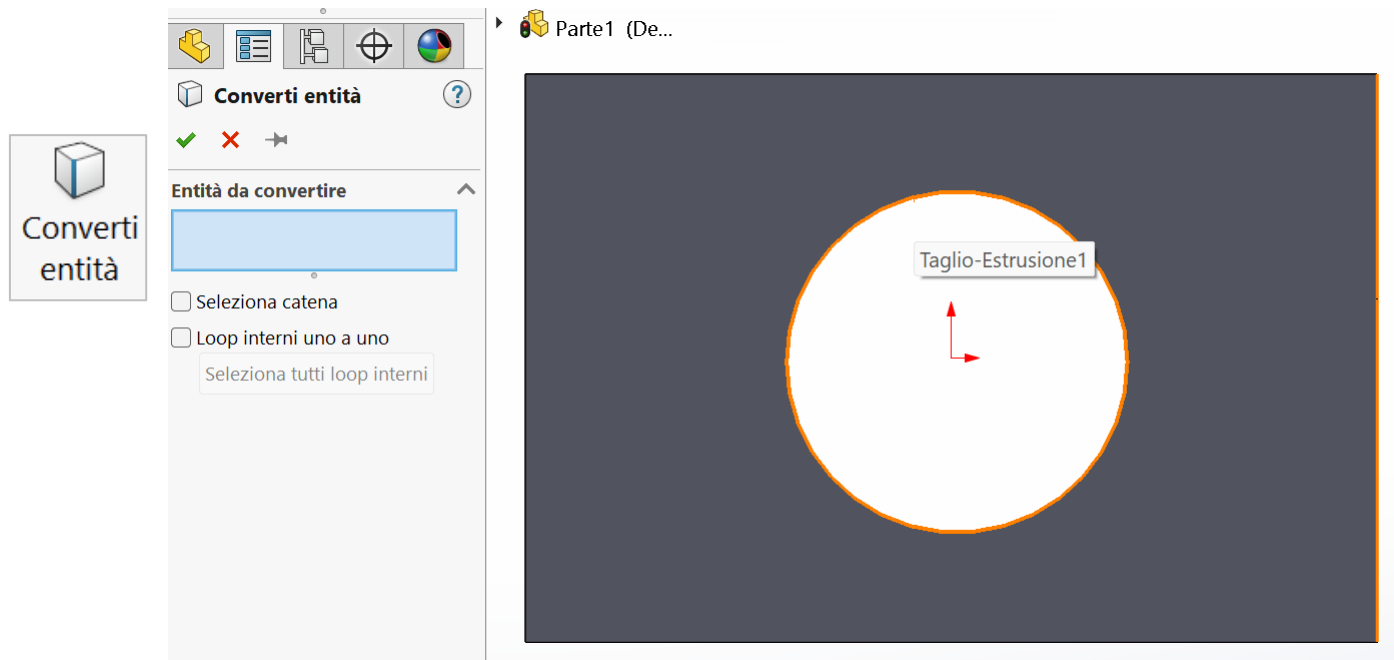

## ESTRUSIONE DI UNO SCHIZZO SU UNA FACCIA DEL PEZZO

Prima si seleziona lo schizzo da estrarre e poi si clicca sul comando di estrusione.

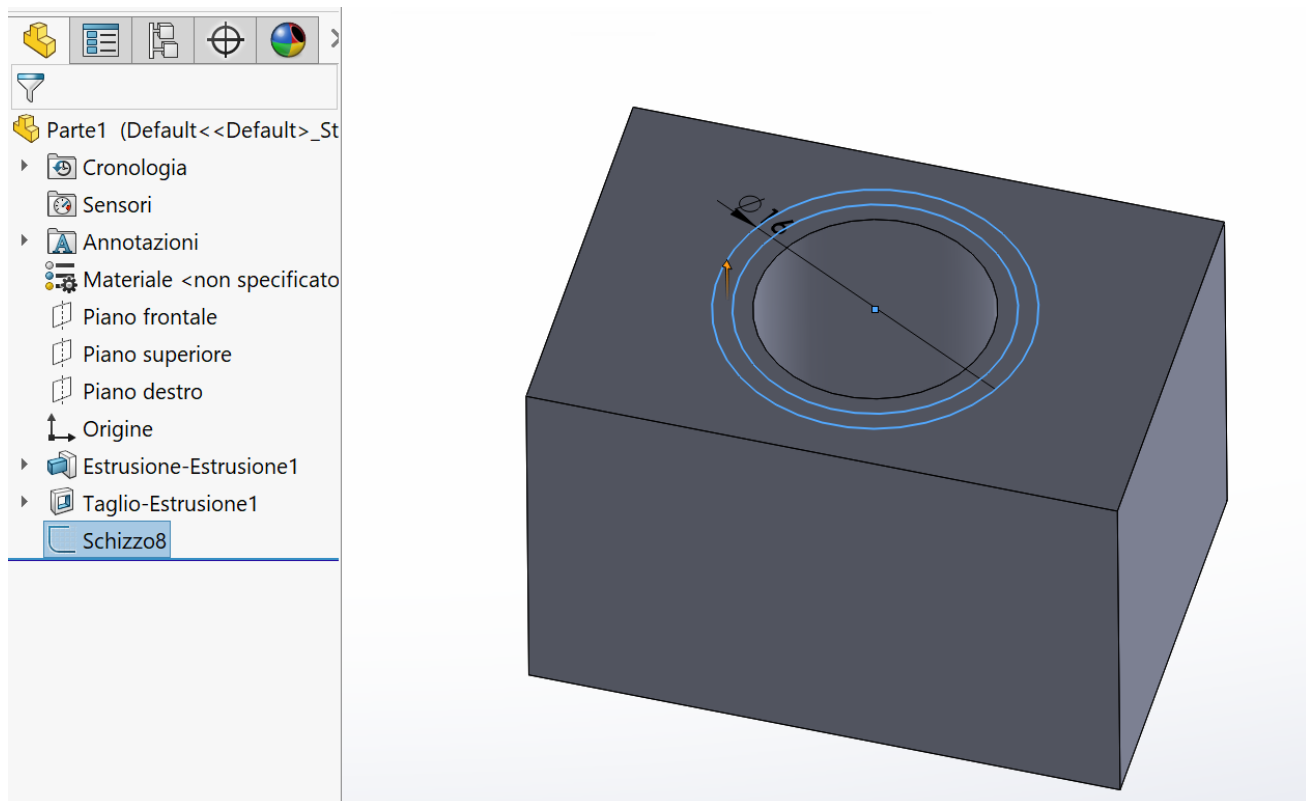

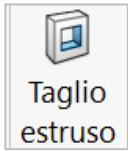

**Estrusione-Estrusione**

Da: Piano di schizzo

Direzione 1: Cieco

2.00mm

Unisci risultato

Sforma esternamente

Direzione 2

Funzione sottile

Contorni selezionati: Schizzo8-Contorno<1>, Schizzo8-Contorno<2>

Parte1 (De...

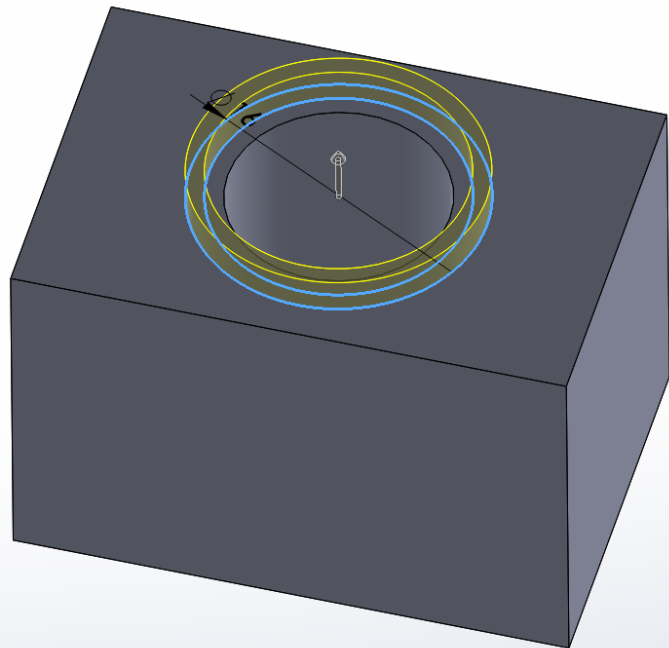

## FORO LISCIO

Prima si impostano le dimensioni e il tipo e poi si seleziona la posizione cliccando prima sulla faccia.

**Specificazione del foro**

Tipo Posizioni

Preferenza: Nessuna preferenza selezionata

Tipo di foro: **ISO** (highlighted)

Standard: ISO

Tipo: Foro

Specifiche del foro: Dimensione: Ø2.0

Mostra dimensionamento personalizzato

Condizione finale: Passante

Opzioni:  Svasatura iniziale,  Svasatura finale

Parte1 (De...

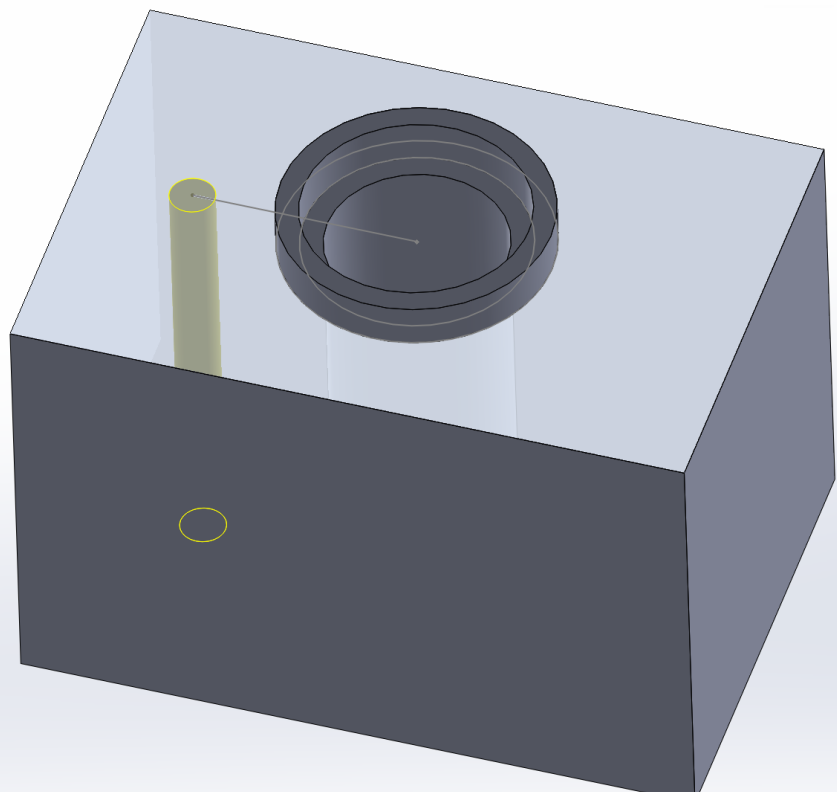

Prima abilitare la filettatura cosmetic nelle proprietà del documento.

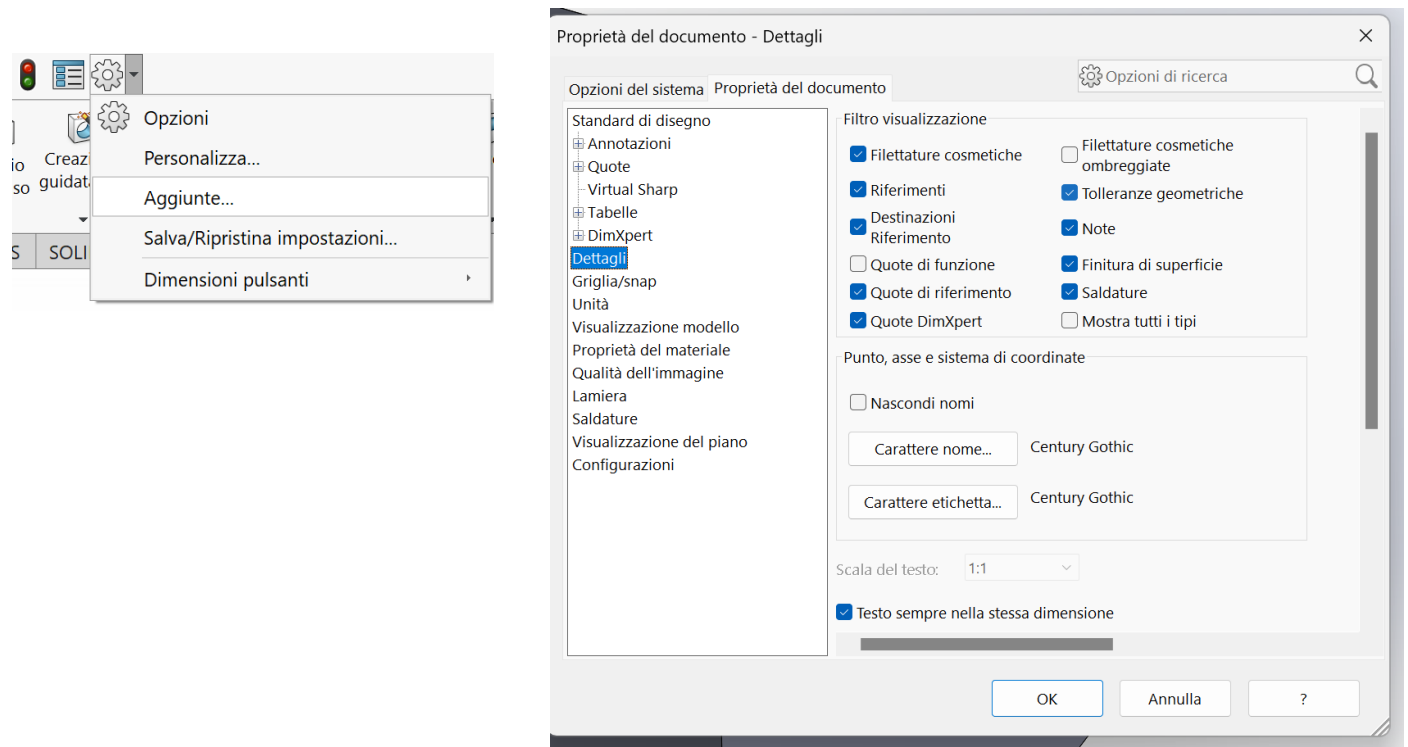

Selezionare foro filettato e nel tipo "preforo standard"

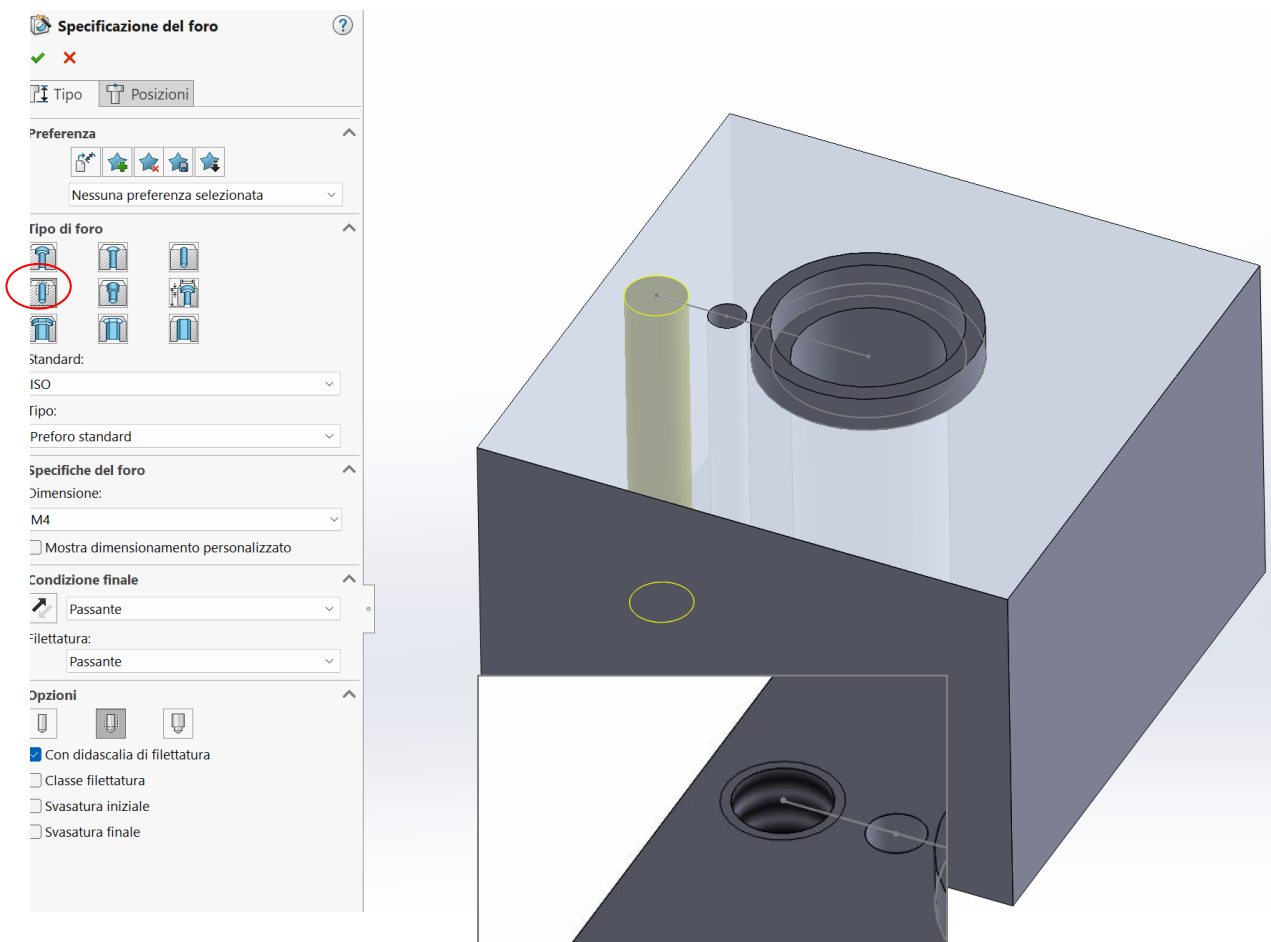

## FORO LAMATO LISCIO

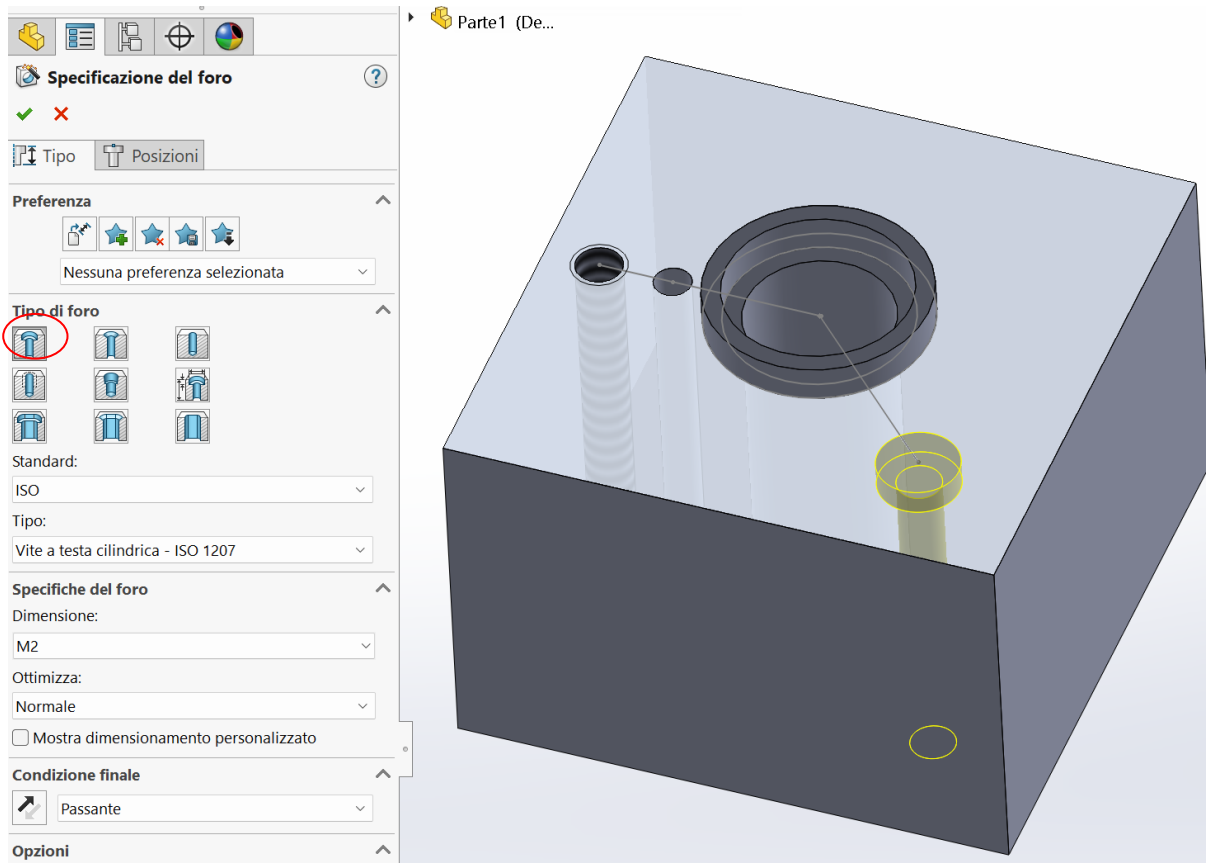

*NB: eventuale filettatura va aggiunta dopo col comando foro filettato!*

## FILETTATURA GEOMETRICA

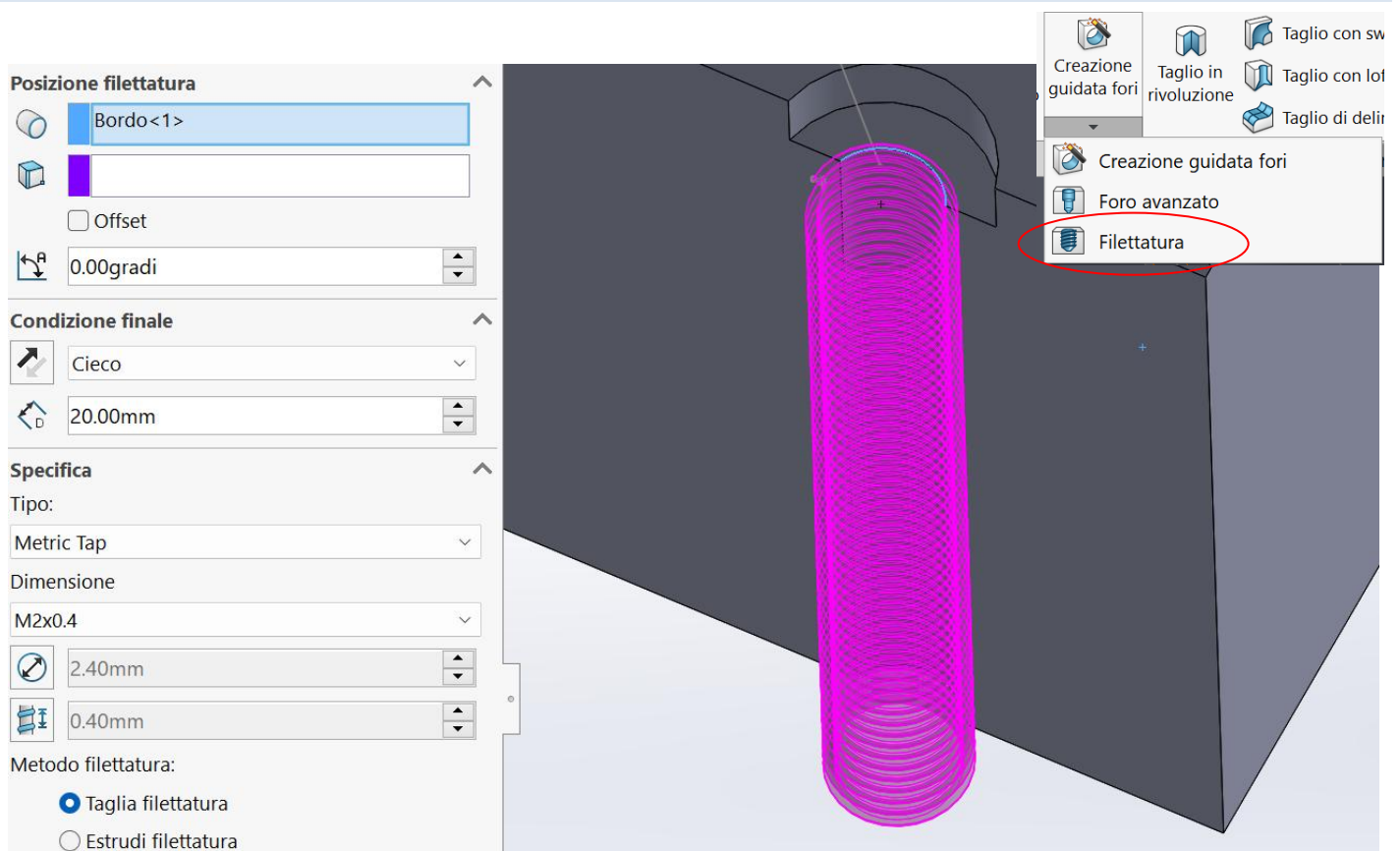

## SERIE CIRCOLARE

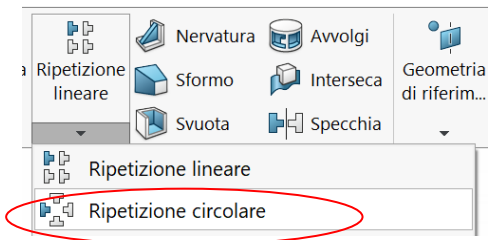

Cliccare nella cella vuota sotto "Direzione 1" per indicare l'asse (selezionare il foro).

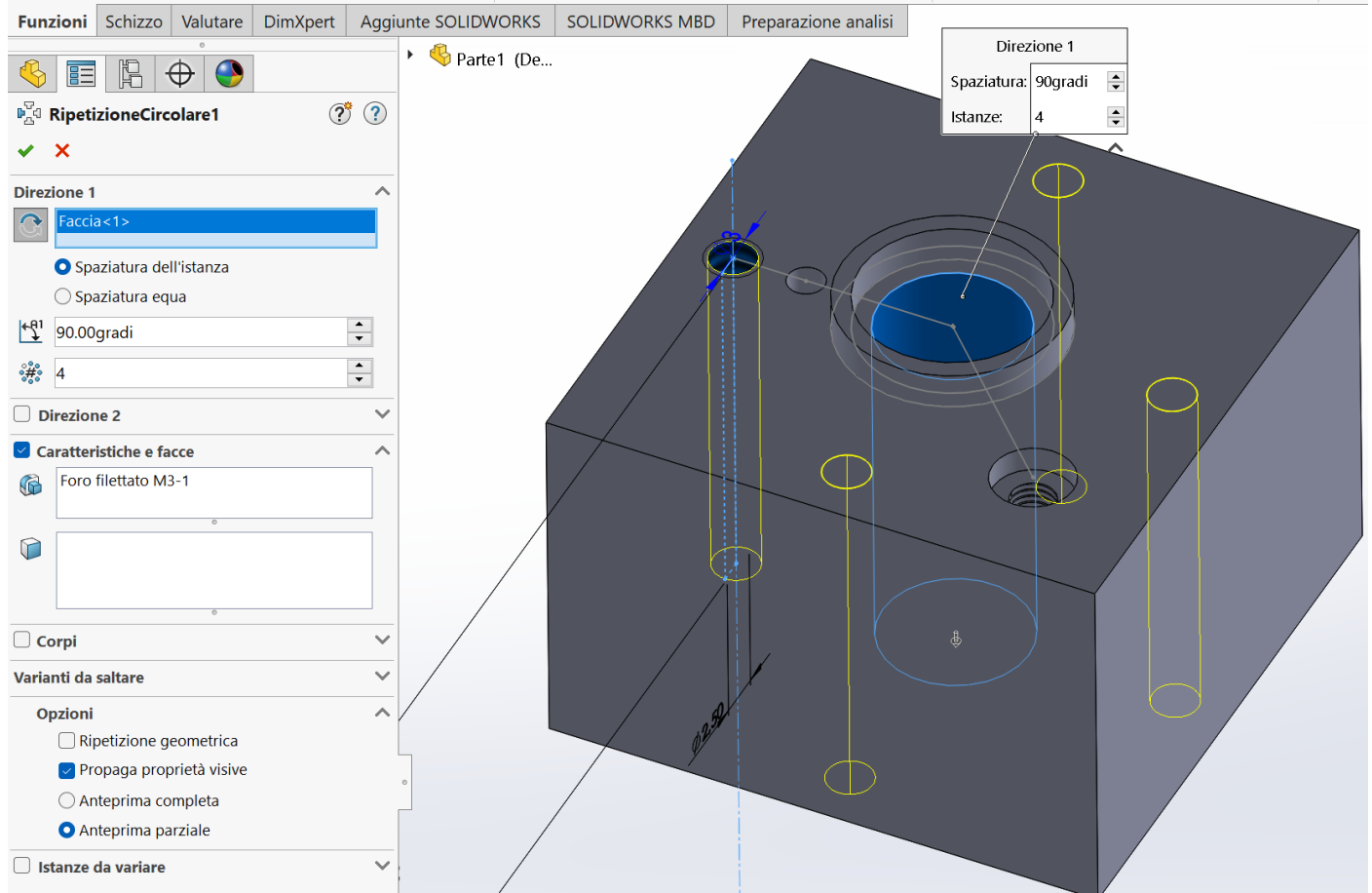

## ASSE DI SIMMETRIA

Se non c'è una geometria cilindrica a disposizione utilizzare l'opzione "punto/faccia".

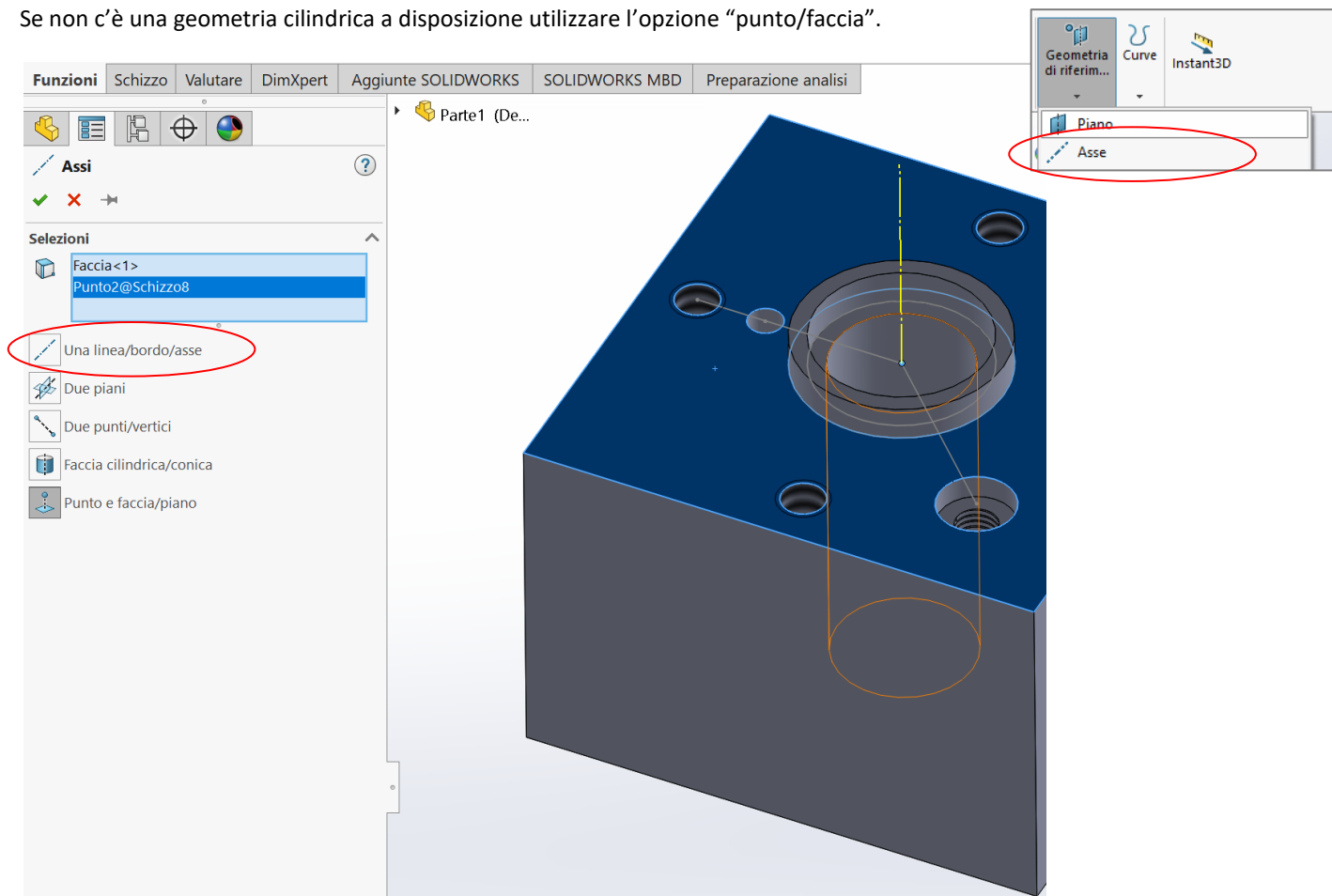

## OFFSET DA PIANO

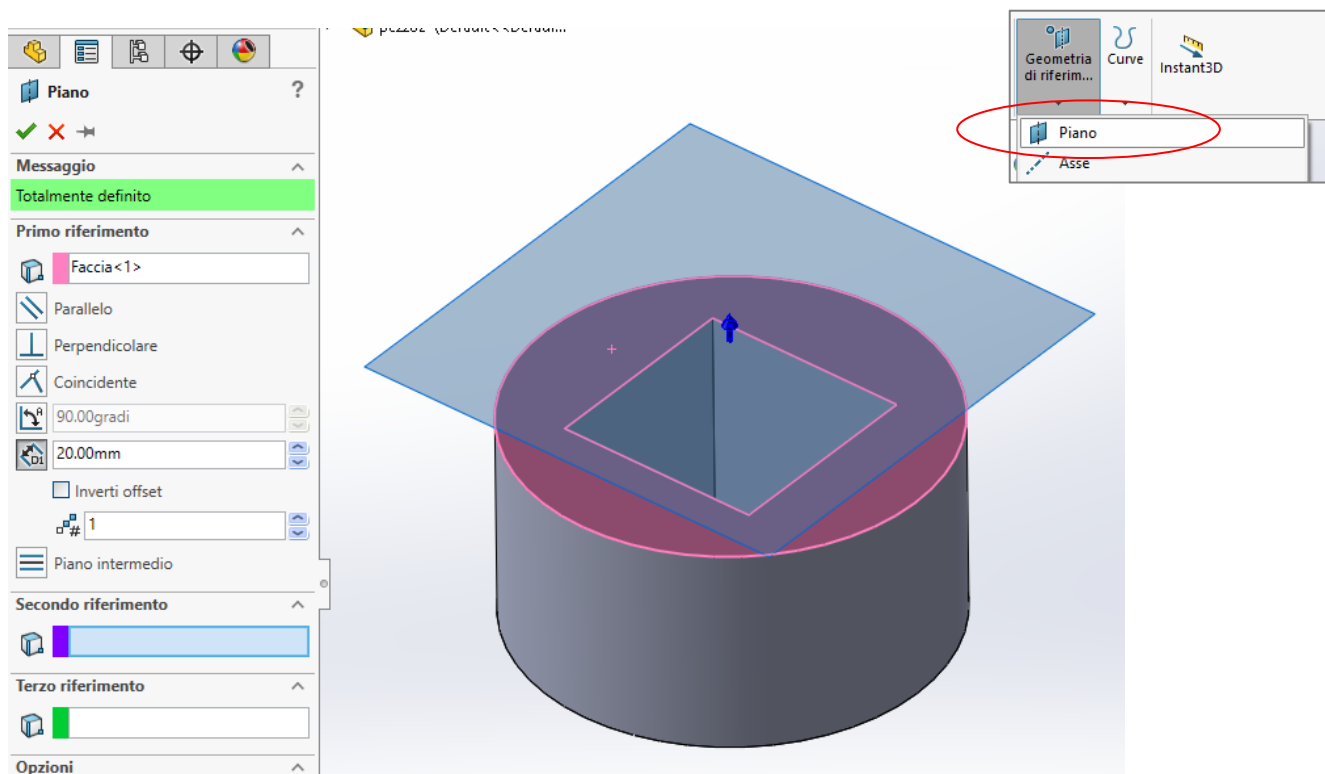

## LOFT

Selezionare I due schizzi che delimitano il solido. E' possibile indicare una curva di mezzeria da seguire (schizzo 3).

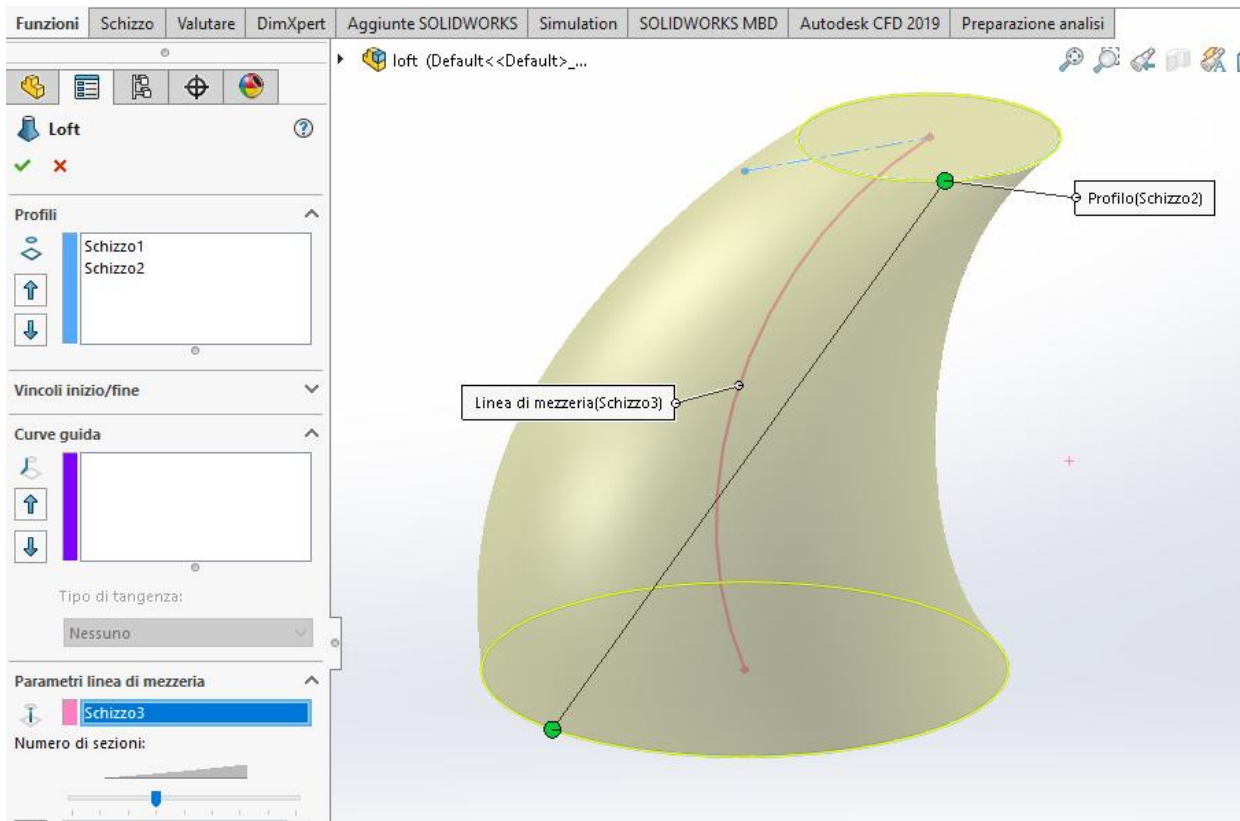

## SWEEP

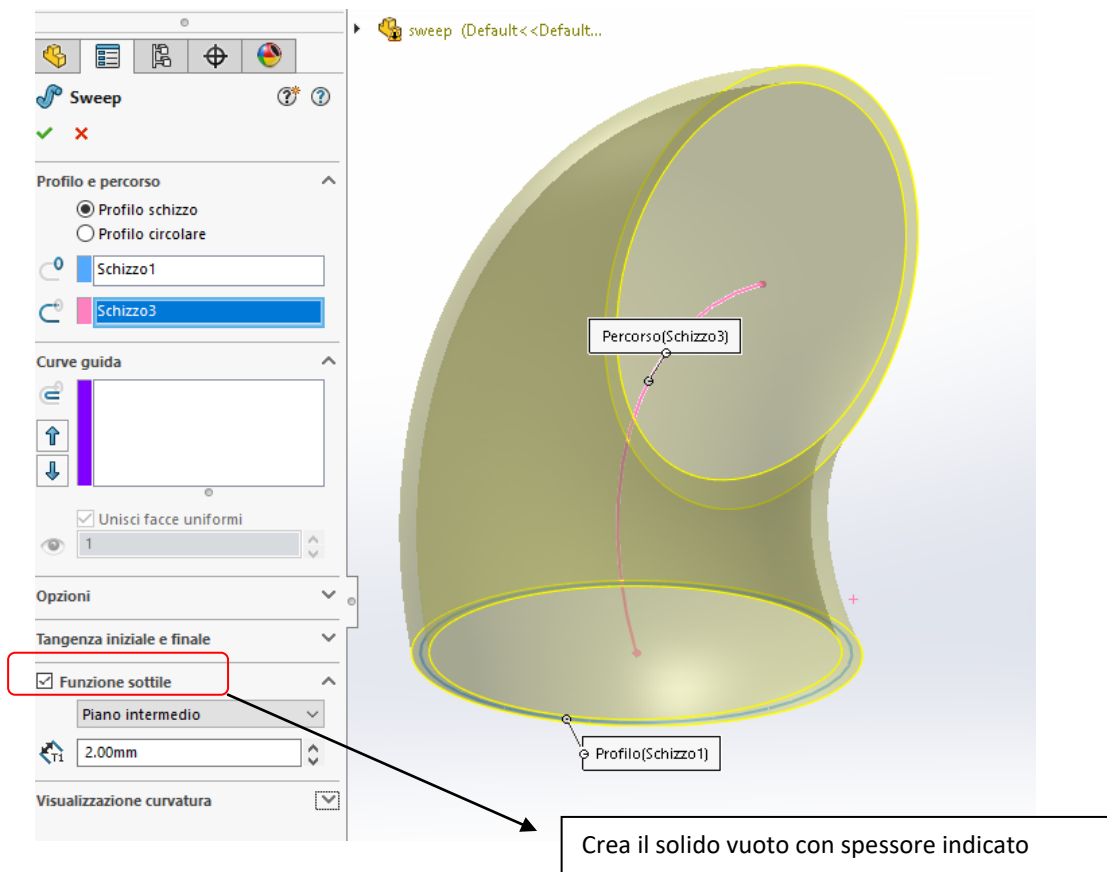

Creare un nuovo assieme e cliccare su inserisci component.

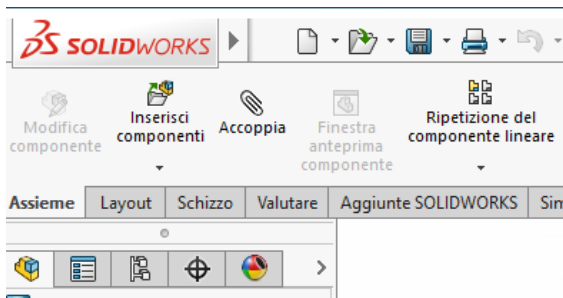

Selezionare la parte da inserire e col menu rapido (tasto destro mouse) ruotare se serve. Cliccare sull'icona verde OK (in alto a destra) per bloccarlo al centro la parte.

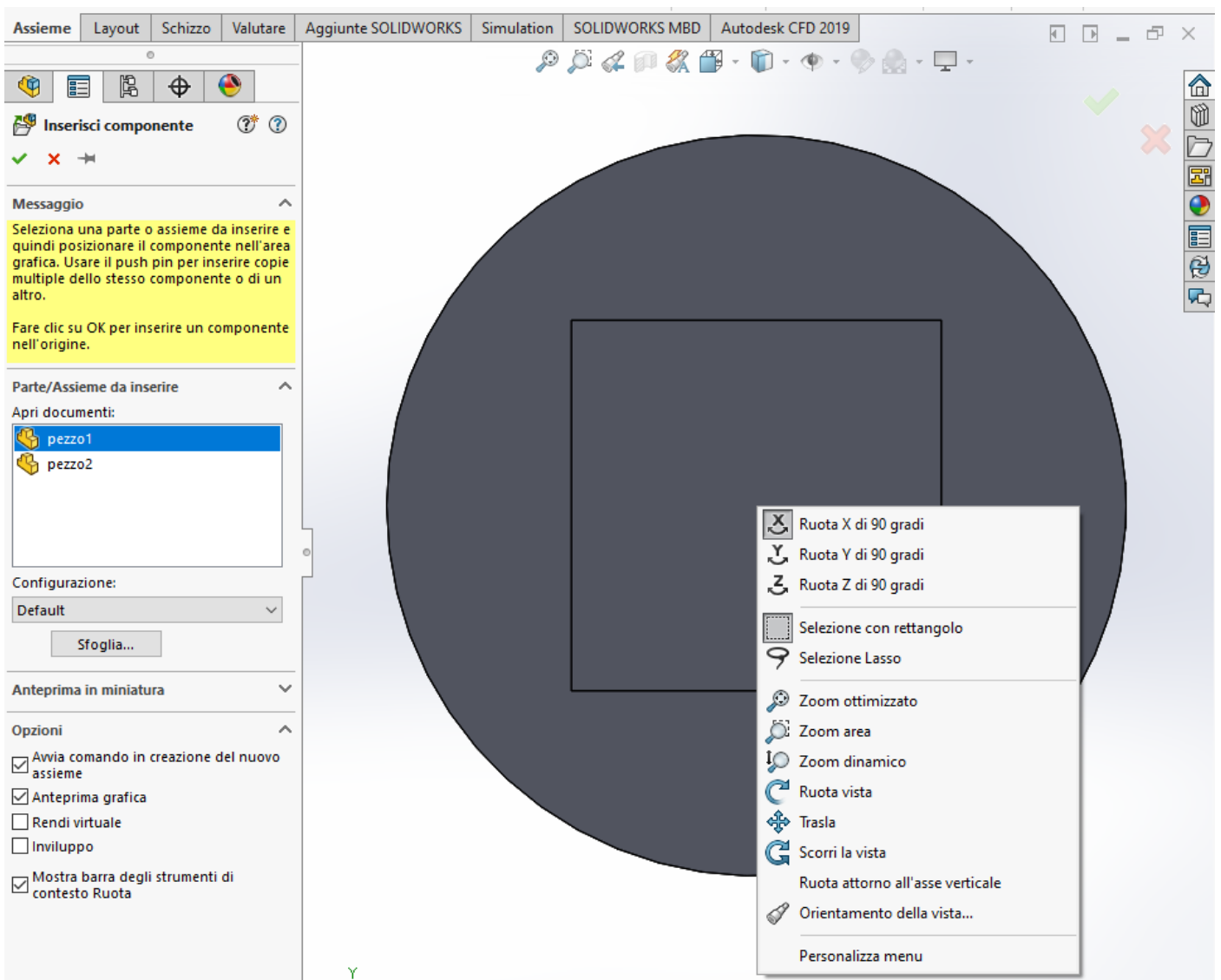

## VINCOLI ACCOPPIAMENTO PARTI

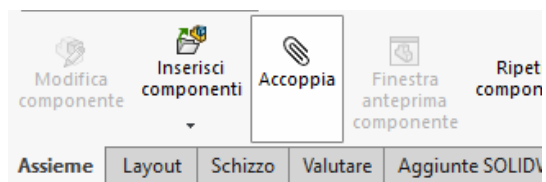

Menu vincoli parti di un assieme

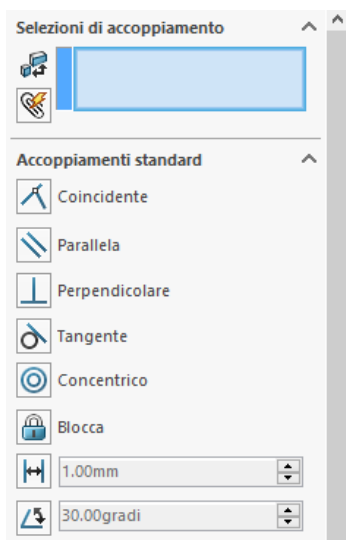

Concentrico (asse)

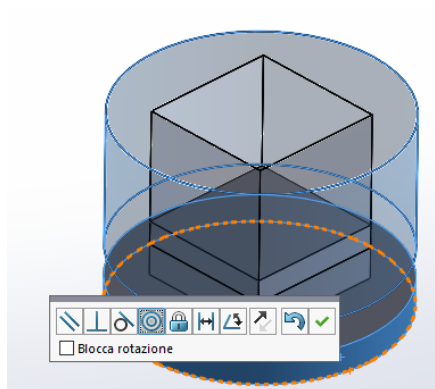

Faccie parallele

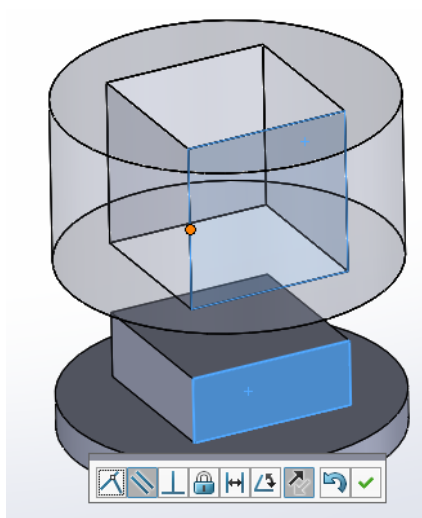

Coincidente

